

TITAN pt. no.: 03 0000 0158

CALIFORNIA NOTICE:



Important: Please read these instructions carefully and completely *before* starting the installation.

TITAN Fuel Tanks™
INSTALLATION GUIDE

Gen 7



Extended Capacity Replacement Tanks for RAM Diesel Trucks

7030125 52 gallon (196 liters)* Fuel Tank for 2025+ RAM Pickup truck models 2500 & 3500 : Crew Cab, Short Bed (6 ft. 4 in.)

No drilling, cutting or fabrication is required for this installation.

Required Tools:

- 1 ea. Ratcheting socket driver
- 1 ea. 16 mm socket
- 1 ea. 12 inch long socket driver extension

Recommended Optional Tools:

- 1 ea. Hydraulic transmission jack
- 1 ea. Impact wrench
- 1 ea. Vehicle Lift

- 1 ea. 7/16 inch socket
- 1 ea. 7/16 inch end wrench
- 1 ea. 9/16 inch socket
- 1 ea. 9/16 end wrench
- 1 ea. 5/8 inch socket
- 1 ea. 5/8 inch end wrench
- 1 ea. 3/4 inch socket
- 1 ea. 3/4 inch end wrench
- 1 ea. Medium flat blade screwdriver
- 1 ea. Needle nose pliers
- 1 ea. Torque wrench handle for socket
- 1 ea. Mallet or small hammer

Generation 7

Tank Body Identification:

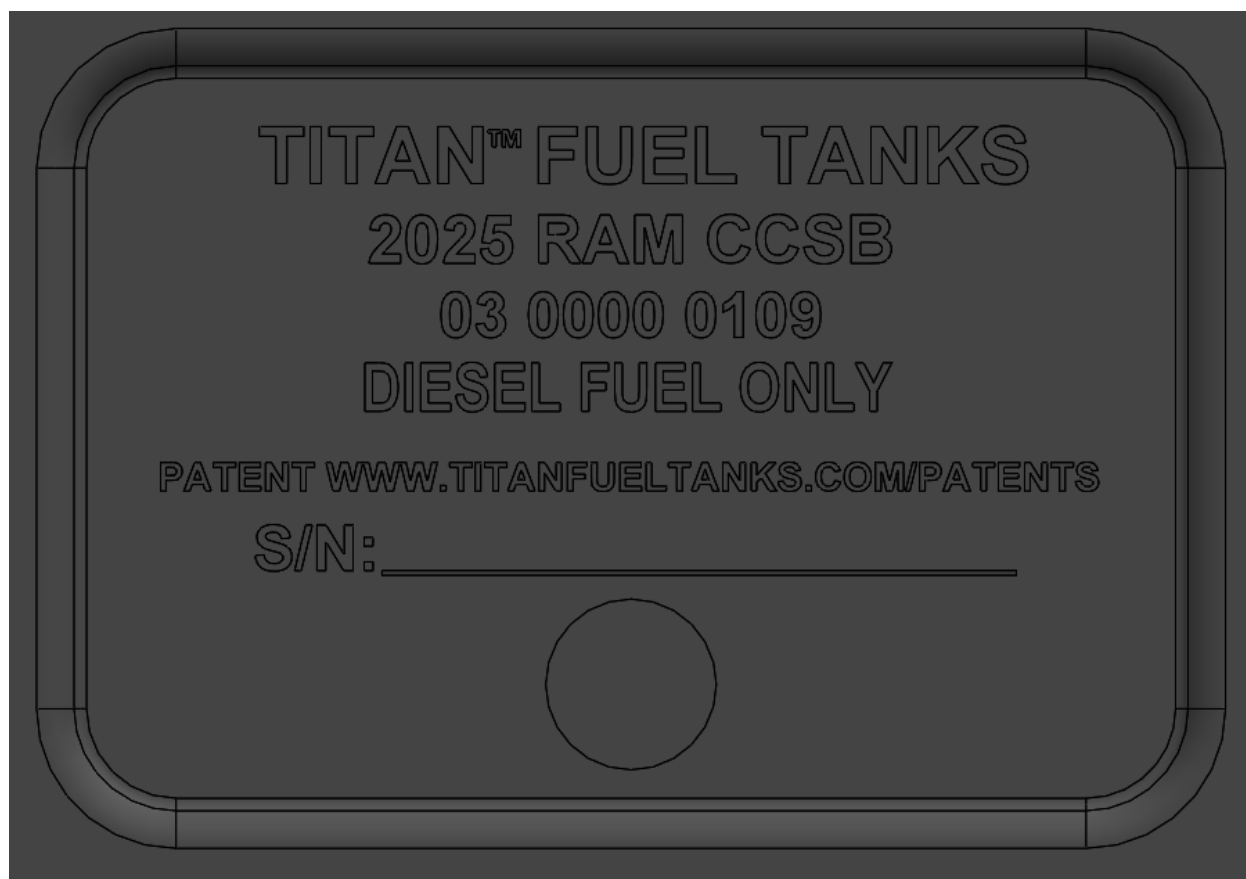

Note: The tank body has the above identification on its bottom. Please check to be sure the tank is properly identified as the one to fit your vehicle. Notice the serial number space. You will need the serial number to register for warranty coverage.

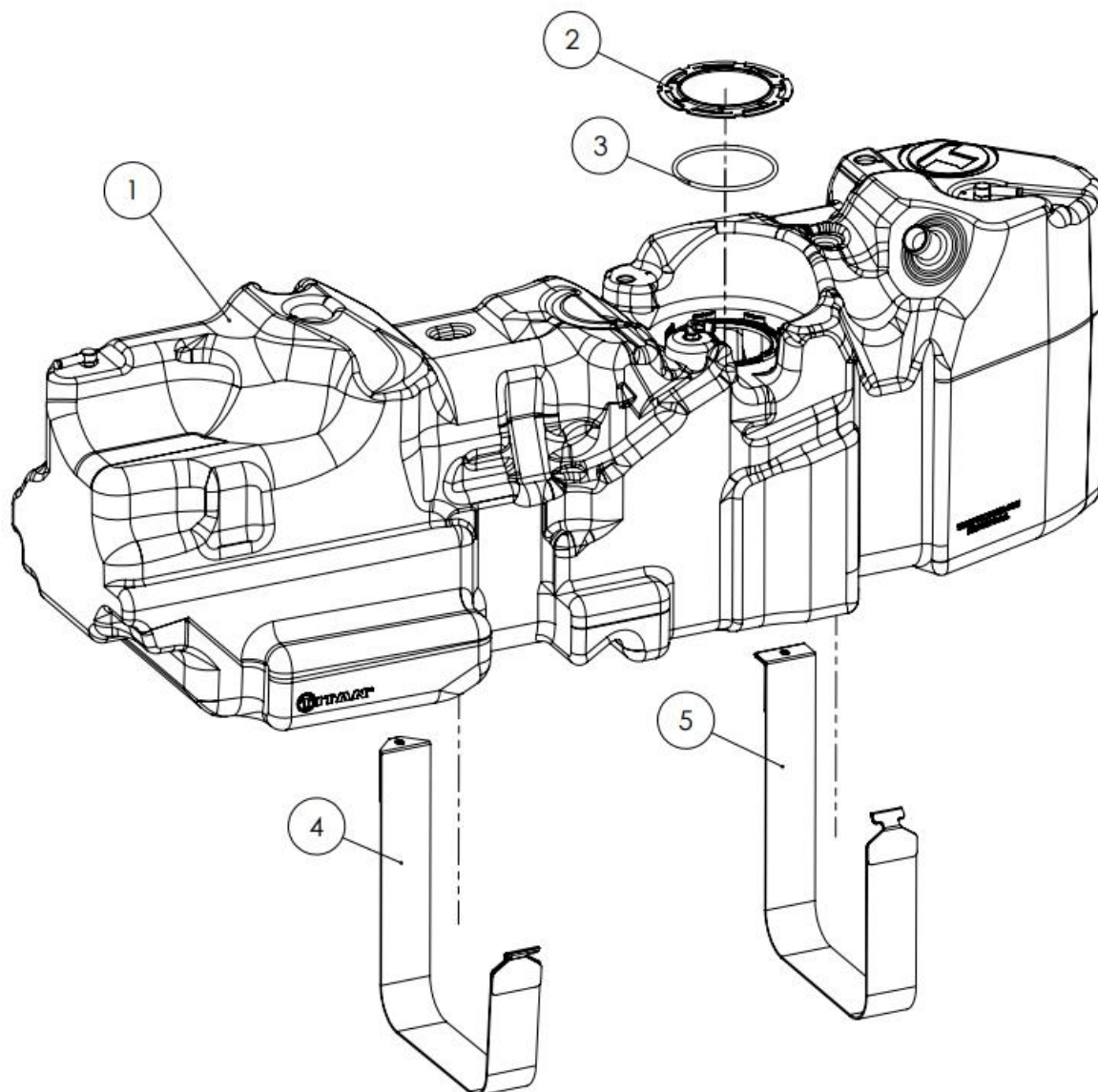

1	03 0000 0117	2025 Dodge CCSB Tank Body
2	98 0000 0403	TITAN Torque Ring™, Locking Top Ring
3	02 0000 0197	TITAN O-Ring
4	03 0126 0000F	2025 RAM CCSB Front Strap
5	03 0126 0000R	2025 RAM CCSB Rear Strap

SAFETY NOTICES

- Be sure to read this entire Installation Guide **before** beginning the installation of the new TITAN fuel tank or fuel system.
- At least a general automotive and mechanical knowledge is recommended to install a new TITAN tank or fuel system.
- TITAN designs its products for use on stock, Original Equipment Manufacturer (OEM) vehicles. TITAN cannot verify all aftermarket vehicle modifications. If the intended vehicle has had modifications to the chassis, suspension, fuel system, or cargo box please call TITAN Fuel Tanks™ before starting the installation.
- Always wear safety glasses
- Only work in a well-ventilated area.
- If any part of the installation requires lifting a heavy object, be sure to use proper lifting techniques.
- KEEP ANY OPEN FLAME OR HEAT SOURCE AWAY FROM THE INSTALLATION AREA.

NOTE: Take a moment and write the new TITAN™ Tank serial number in the back of this instruction booklet now. The serial number is found on the bottom of tank.

IMPORTANT NOTICE: Before installation, be sure to thoroughly inspect inside of the tank for ANY foreign debris!

I. Remove Original Equipment Tank

- | Step | Description |
|------|--|
| 1 | Using best, safe practices, place the vehicle on a hoist that leaves the entire underside of the frame <i>unobstructed</i> . |
| 2 | Drain all the fuel from the OEM tank using a TITAN Fuel Caddy or siphon. |
| 3 | Remove the driver's side rear tire and fender liner to allow access to the vehicle's fill neck. |



- | | |
|----|--|
| 4 | Disconnect the 3/4" vent line hose and the larger fill hose from the fill neck, leaving them attached to the tank. |
| 5 | Disconnect the drive shaft from the rear axle for working clearance. |
| 6 | Remove OEM side and bottom tank shields, if equipped. |
| 7 | Support the OEM Tank with a jack. |
| 8 | Loosen OEM tank straps by undoing inside bolts first. |
| 9 | Disconnect the 5/16" vent line running from the fill neck to the rear of the OEM tank. This line will not be used on the new TITAN tank. |
| 10 | Lower the tank slightly and disconnect fuel gauge electrical connection, feed line and return line from the sending unit. You can disconnect the short feed line from the vehicle and leave it on the sending unit if desired. |
| 11 | Remove the OEM tank with its straps from the vehicle. |

- 12 Secure the wiring harness and differential breather hose to the frame to clear space for a new tank.
- 13 Use a mallet and screwdriver or punch to loosen the locking top ring on the sending unit by tapping it and turning it counterclockwise. Remove the sending unit from the OEM tank. Do NOT reuse factory O-Ring seal.



- 14 Remove fill hose and vent line hose from original equipment tank, they will be installed the same way on the new tank.

II. Prepare Vehicle and Replacement Tank

Step	Description
------	-------------

- | | |
|----|--|
| 15 | The new TITAN fuel tank comes with a new O-Ring to seal the sending unit. The O-Ring is packaged in the envelope with the warranty registration. Install the O-Ring as shown below. |
|----|--|



- | | |
|----|---|
| 16 | Before installing the sending unit into the TITAN Tank, BE SURE THE INSIDE OF THE TANK IS FREE OF DIRT OR DEBRIS OF ANY KIND. Carefully place the sending unit into the new TITAN tank. |
| 17 | Carefully place the sending unit into the TITAN Tank. |
| 18 | After placing the sending unit into the tank on top of the O-ring gasket, rotate it until the sending unit tab is lined up with the "TAB LOCATION" marking on the tank's top. |



- 19 Place the provided TITAN Torque Ring, Locking Top ring on top of the sending unit and use a hammer and punch, or screwdriver to tap the ring clockwise until it is fully seated and locked. The short feed line may be installed on the sending unit at this time.



- 20 Install the fill hose on the TITAN Tank King Nipple and the $\frac{3}{4}$ " vent line hose on the $\frac{3}{4}$ " elbow which is installed on top of the tank. Be sure all clamps are tight.



III. Install Replacement Tank in Vehicle

Step	Description
------	-------------

- | | |
|----|---|
| 21 | Place Titan tank on transmission jack. Raise until close enough to reconnect sending unit electrical connector, return, and feed lines. Remove hose clip if needed. |
|----|---|



- | | |
|----|---|
| 22 | Once all connections are securely attached, lift the tank the rest of the way into place with the jack. |
| 23 | Fit straps in-board first, then fit into "T" Bracket. Install nut on in-board side and tighten to OEM specification. |
| 24 | Attach the fill hose and the vent line hose to the vehicle's filler neck as they were with the original equipment tank. |
| 25 | Make sure ALL mounting hardware, clamps, bolts, etc. are properly installed and TIGHT. Double check it. |
| 26 | Reconnect the drive shaft to the rear axle. |
| 27 | Reinstall the fender liner and the rear tire and wheel. |

- 28 Lower vehicle, fill tank with diesel fuel and check for leaks. IMPORTANT!**



Installation Complete!

Gen 7 XXL Tank Drilling Instructions

Important: Please read through all instructions fully before starting.

Step 1: Remove the Plug

- Begin by safely removing any existing plug or cap from the tank to allow access to the area you'll be drilling.

Step 2: Set Up a System to Catch Shavings

- To prevent debris from entering the tank and causing damage, set up a system to catch the plastic shavings. Options could include:
 - Placing a rag or cloth inside the tank to catch the shavings.
 - Using a vacuum with a hose directed at the drilling site to suck up the shavings as you work.

Step 3: Drill the Holes

- Start with a small pilot drill bit, and gradually increase the drill bit size to achieve the desired hole diameter. A small amount of grease on the drill bit can catch some of the plastic shavings from falling into the tank.
- Be careful to drill as large as possible without damaging the threads or surrounding plastic. Take your time, and avoid contacting the threads.
- Be careful to drill only the necessary holes for the intended kit.



Fast Fill Kit



Universal Pickup Tube and Return System

Step 4: Trim the Inside of the Holes

- After drilling, use a razor blade or utility knife to carefully trim the inside of the hole, ensuring it's flush with the threads. This step helps smooth out any rough edges and ensures a clean fit for the fittings.

Step 5: Clean the Tank

- Once you've finished drilling and trimming, carefully remove all plastic shavings from inside the tank. Use compressed air, a vacuum, or a damp cloth to ensure the tank is completely free of debris. This is crucial to avoid any plastic pieces entering the fuel system, as they could cause damage or clog components.

Gen 7 Fast Fill Vent Kit (9901770) Install

Step 1: Drill Out Holes

- Follow the drilling instructions above carefully.

Step 2: Apply Thread Seal Tape

- wrap the threads of the valve in thread seal tape (Teflon tape).

Step 3: thread valve into tank

- Carefully thread the roller valve into the tank, ensuring you do not cross-thread it.



Go to TITAN's website to view video installation instructions and tips.

Be sure to return the completed warranty registration for your new Titan fuel tank; or you can register on-line at www.titanfueltanks.com

You will find your tank's serial number on the bottom of the tank.

Write your tank's Serial Number here: _____

A product must be registered within sixty (60) days of receipt for the warranty to be valid. Other conditions may apply. Consult TITAN's full warranty for details.

*All capacities are approximate.

Warranty is void if product is improperly installed.

For questions or customer service call (800) 728-4982

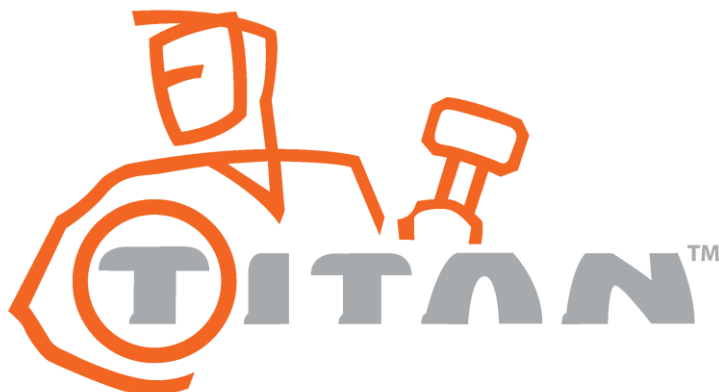

TITAN Fuel Tanks™
P.O. Box 2225
Idaho Falls, ID 83403 USA
Telephone (208) 522-1325, FAX (208) 529-2162
www.titanfueltanks.com

For patent information: <http://titanfueltanks.com/patents>

TITAN Fuel Tanks are PROUDLY MADE IN THE USA!

Revised 11.25.2025

©2025 Supertanks, LLC. All rights reserved.