

TITAN pt. no.: 99 0000 0667

# TITAN™ Fuel Tanks

## ASSEMBLY ILLUSTRATIONS

# Fuel Caddy



Shown with power cord which is not included (to be wired by local electrician). 12 v. version includes battery bracket

### TITAN™ Shop Equipment

**100 Gallon Fuel Caddy, 110 volt AC** (6000003)  
**100 Gallon Fuel caddy, 12 volt DC** (6000004)

**NOTE:** For 6000003 110 volt AC Fuel Caddy, a local electrician will be required to provide and attach power cord due to local regulations.

Assemble the fuel caddy as per the diagrams shown below.

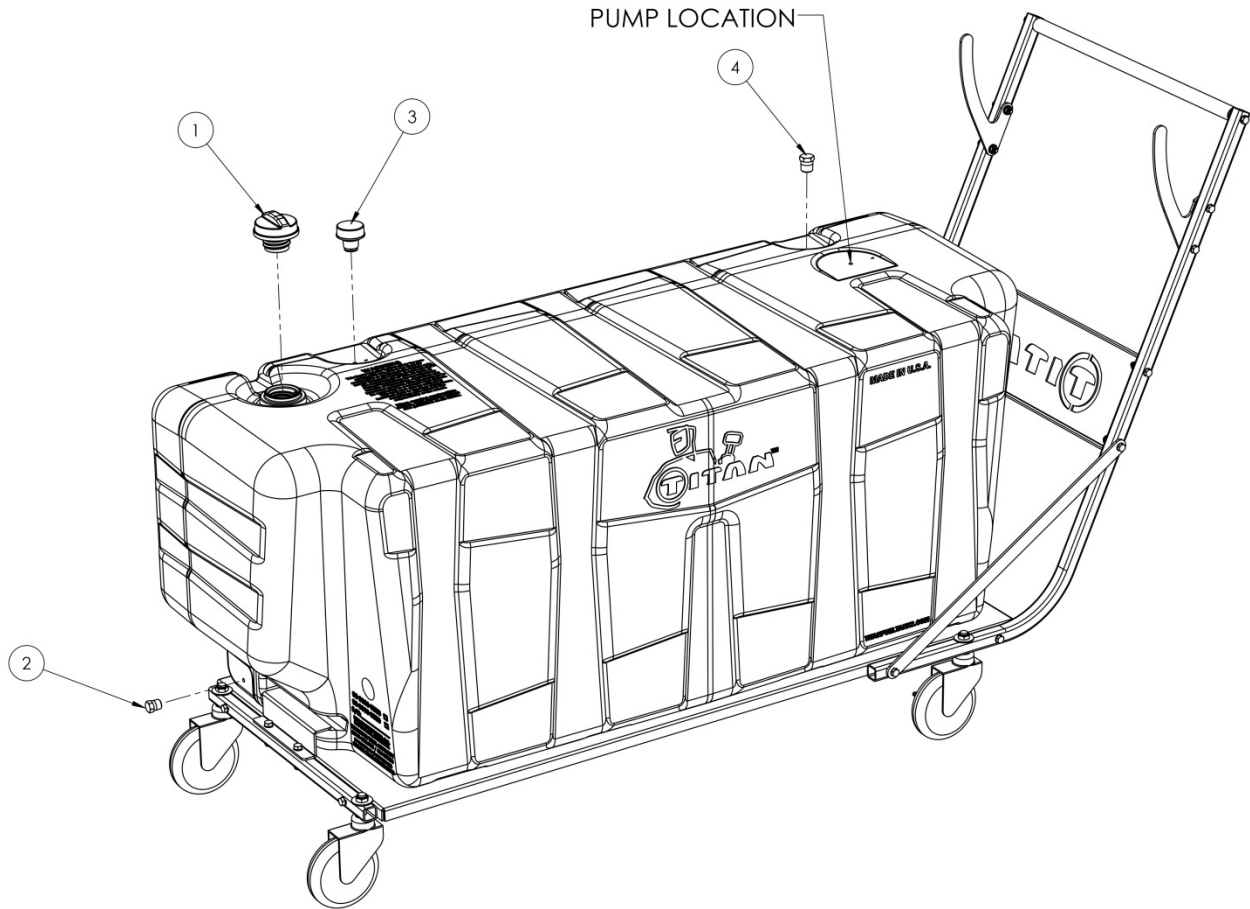

## Tank Parts

| ITEM NUMBER | PART         | QUANTITY |
|-------------|--------------|----------|
| 1           | Fuel Cap     | 1        |
| 2           | 3/8 NPT Plug | 1        |
| 3           | Vent Cap     | 1        |
| 4           | 1/2 NPT Plug | 1        |

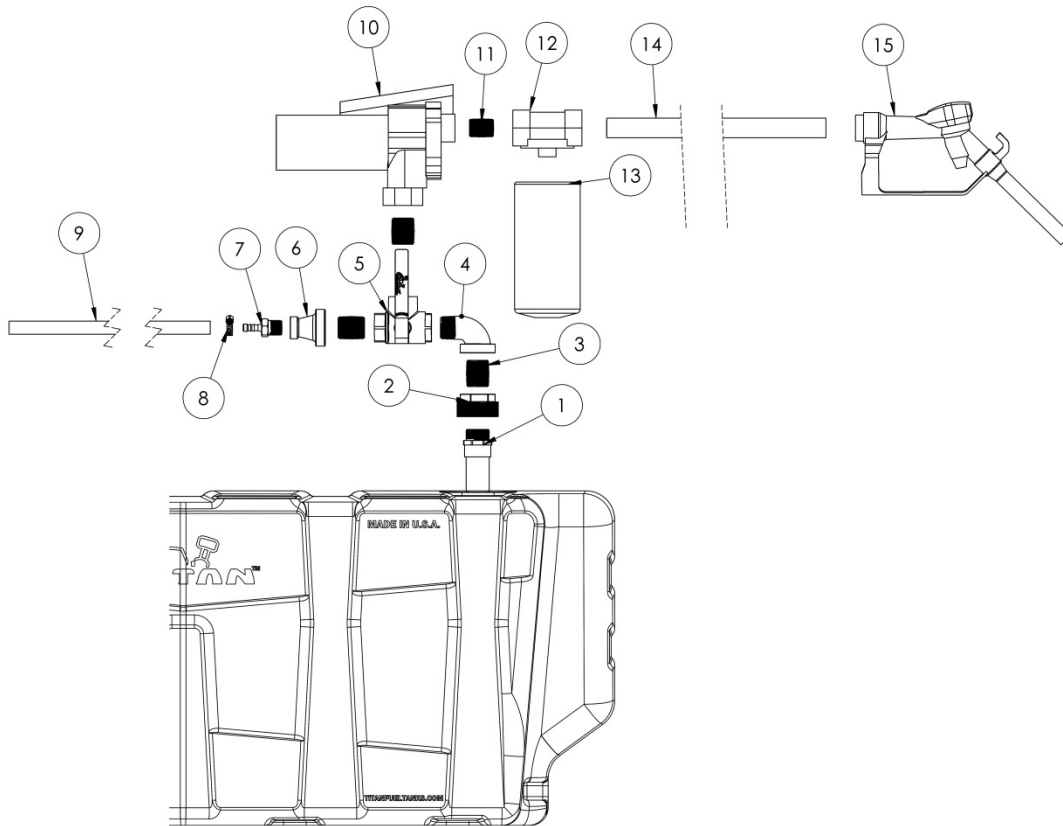

## Plumbing Diagram

| ITEM NUMBER | PART                         | QUANTITY |
|-------------|------------------------------|----------|
| 1           | Pickup Tube                  | 1        |
| 2           | 2" Threaded Tank Fitting     | 1        |
| 3           | 1" Pipe Nipple               | 3        |
| 4           | 1" Street Elbow              | 1        |
| 5           | 3-Way Ball Valve             | 1        |
| 6           | Reducing Coupling            | 1        |
| 7           | Pipe to Hose Adapter         | 1        |
| 8           | Hose Clamp                   | 1        |
| 9           | 3/8" Hose, 10 ft             | 1        |
| 10          | Pump                         | 1        |
| 11          | 3/4" Pipe Nipple             | 1        |
| 12          | Filter Adapter               | 1        |
| 13          | Water and Particulate Filter | 1        |
| 14          | 3/4" Fuel Hose               | 1        |
| 15          | Fuel Nozzle                  | 1        |

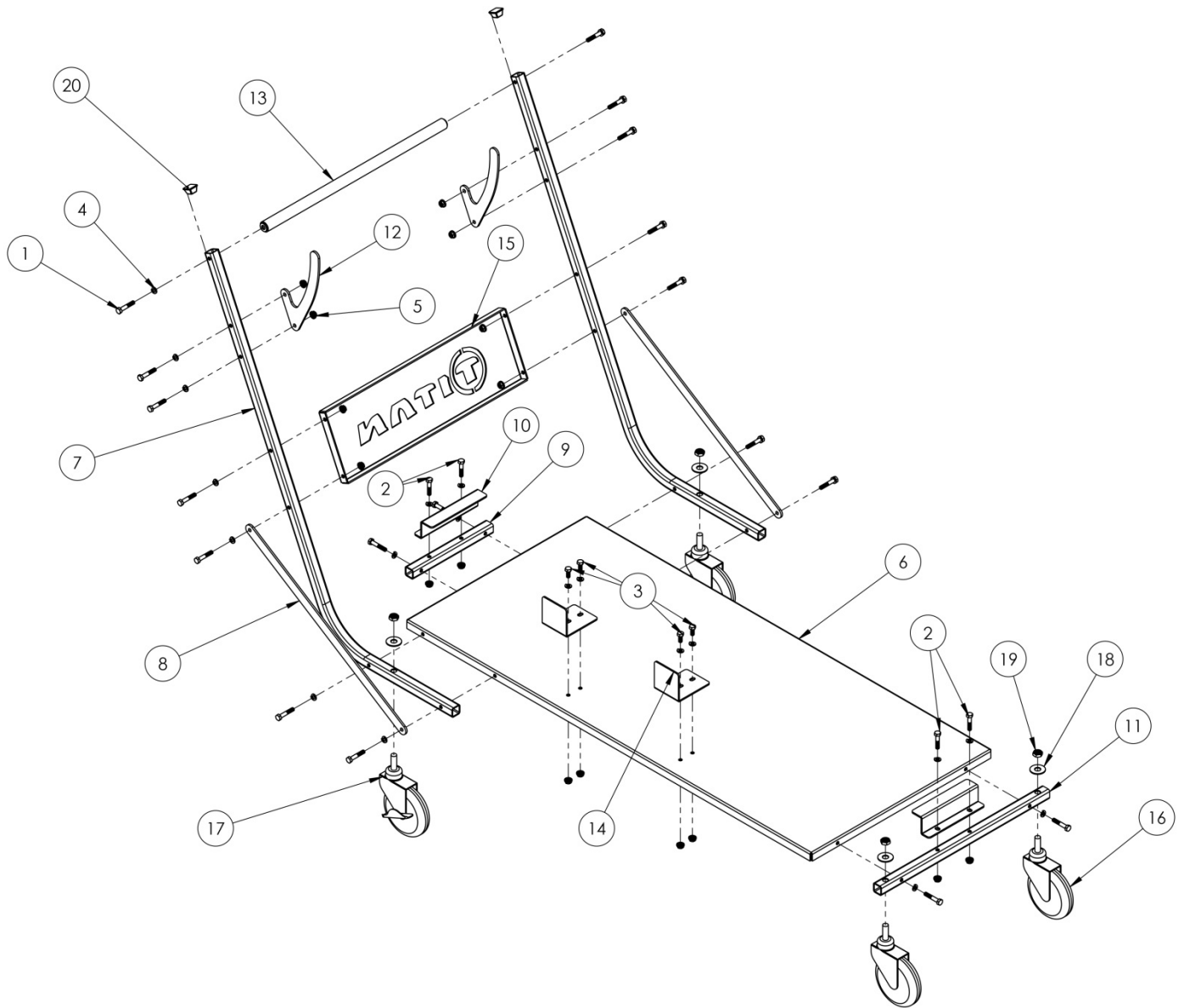

## Trolley Assembly

| ITEM NUMBER | PART                               | QUANTITY |
|-------------|------------------------------------|----------|
| 1           | 5/16"-18 X 1-3/4" Length Cap Screw | 18       |
| 2           | 5/16"-18 X 1-1/2" Length Cap Screw | 4        |
| 3           | 5/16"-18 X 3/4" Length Cap Screw   | 4        |
| 4           | 5/16" Lock Washer                  | 26       |
| 5           | 5/16" Flanged Locknut              | 24       |
| 6           | Trolley Baseplate                  | 1        |
| 7           | Trolley Handle Support             | 2        |

|    |                            |   |
|----|----------------------------|---|
| 8  | Trolley Strut              | 2 |
| 9  | Rear Mount Support         | 1 |
| 10 | Tank Toe Clamp             | 2 |
| 11 | Front Mount Support        | 1 |
| 12 | Trolley Hanger Bracket     | 2 |
| 13 | Trolley Handle             | 1 |
| 14 | Tank Side Support          | 2 |
| 15 | "TITAN" Rear Stiffener     | 1 |
| 16 | Caster Wheel               | 2 |
| 17 | Caster Wheel with Brake    | 2 |
| 18 | 1/2" Flat Washer           | 4 |
| 19 | 1/2"-13 Thin Nylon Locknut | 4 |
| 20 | Square Tube Insert         | 2 |

**See instruction documents included with the pump and accessories.**

**Be sure to return the completed warranty registration for your new Titan™ Fuel Caddy;  
or you can register on-line at [www.titanfueltanks.com](http://www.titanfueltanks.com)**

**You will find your caddy tank's serial number located on the side of the tank.**

**Write your tank's Serial Number here: \_\_\_\_\_**

**A product must be registered within sixty (60) days of receipt for the warranty to be valid.**

**Warranty is void if product is improperly assembled installed.**

**For questions or customer service call (800) 728-4982**



**TITAN™  
P.O. Box 2225  
Idaho Falls, ID 83403 USA  
Telephone (208) 522-1325, FAX (208) 529-2162  
[www.titanfueltanks.com](http://www.titanfueltanks.com)**

***TITAN Products are PROUDLY MADE IN THE USA***

Revised 5.21.15

©2015 Supertanks, LLC